

SteelcraftTM

Express Umbrella Layback Stroller

BRITAX CHILDCARE PTY. LTD A Britax International company.
(Incorporated in Victoria) A.B.N. 55 006 773 600
99 Derby Road, Sunshine, Victoria 3020, Australia
Phone: (03) 9288 7288 Fax: (03) 9311 5798

CUSTOMER SERVICE
1300 303 330 - Australia 0508 688 822 - New Zealand

Due to our continuing program of development, Britax reserves the right to alter the specifications, color or design without any further notice.

The Steelcraft trademark is the property of Britax Childcare Pty.Ltd - Australia.

The Britax trademark is the property of Britax Excelsior Limited - UK.

Visit the Britax website at: www.britax.com.au or email us at au-custserv@britax.com

Due to the variations in the style and design of our products the illustrations used in this instruction booklet are generic.

This product is designed to comply with Australian and New Zealand standard AS/NZS2088 "Prms and Strollers - Safety Requirements."

©2010 Copyright Britax Childcare Pty. Ltd. Australia



IMPORTANT: KEEP THIS BOOKLET IN A SAFE PLACE FOR FUTURE REFERENCE.

SteelcraftTM

SteelcraftTM

RETAIN FOR FUTURE REFERENCE.
READ ALL INSTRUCTIONS CAREFULLY BEFORE ASSEMBLY AND USE
OF THIS STROLLER. ALWAYS FOLLOW THE INSTRUCTIONS.
THE CORRECT USE AND MAINTENANCE OF THIS PRODUCT IS
ESSENTIAL.

WARNINGS: TO AVOID INJURY OR DEATH:

**ALWAYS APPLY THE BRAKES WHENEVER THE STROLLER IS
STATIONARY.**

- FOLLOW THE MANUFACTURERS INSTRUCTIONS.
- DO NOT LEAVE CHILDREN UNATTENDED.
- SECURE THE CHILD IN THE HARNESS AT ALL TIMES.
- DO NOT CARRY EXTRA CHILDREN OR BAGS ON THIS STROLLER.
- MAKE SURE CHILDREN ARE CLEAR OF ANY MOVING PARTS IF YOU ADJUST THE STROLLER.
- USE THE HARNESS AT ALL TIMES.
- WHEN NOT IN USE DISCONNECT SHOULDER STRAPS FROM THE WAIST STRAPS AND BUCKLE TO PREVENT STRANGULATION.
- Check that all safety locks are engaged before placing a child in the stroller.
- Ensure your child is secured with a correctly adjusted safety harness.
- Use the tether strap to prevent the stroller from rolling away.
- Never let go of the stroller when parked on an incline because it may slide or tip over. Always park on a flat surface.
- Remove the child from the stroller before going up or down stairs or escalators.

CARE AND MAINTENANCE

- To prolong the life of your stroller keep it clean and do not leave it in the direct sunlight or in the car boot for extended periods of time.
- Removable fabric covers and trims may be cleaned using warm water with a household soap or mild detergent. Allow it to dry fully, preferably away from the direct sunlight.
- Non removable fabric covers and trims may be spot cleaned using a damp sponge with soap or a mild detergent. Allow it to dry completely before folding or storing it away.
- In some climates the covers and trims may be affected by mould and mildew. To help prevent this occurring, do not fold or store the product if it is damp or wet. Always store the product in a well ventilated area.
- When using your stroller at the beach - completely clean your stroller afterwards to remove the sand and salt from the mechanisms and wheel assembly. Sand and salt will cause premature wear and corrosion.
- If there are compression marks on the tyres - Use a domestic hair dryer to gently warm (DO NOT OVERHEAT) the tyre and the compression marks should slowly disappear.
- Always check parts regularly for tightness of screws, nuts, and other fasteners - tighten if required. To maintain the safety of your nursery product, seek prompt repairs for bent, torn, worn or broken parts.

THIS PRODUCT IS NOT INTENDED FOR COMMERCIAL USE.

WARNINGS

- Do not allow children to stand on the seat.
- Do not hang bags or goods from the handle as this could cause the stroller to tip over.
- To prevent the risk of the stroller catching fire, do not park it near an exposed heat source such as a radiator, an open fire or a barbecue, etc.
- Do not run while using this product.
- Always lock swivel wheels when on rough surfaces as this will help eliminate wheel wobble.
- Always raise the leg support (where fitted) to its highest position when transporting a baby. This will reduce the risk of the baby falling out through the front of the stroller.
- It is unsafe to use accessories other than those tested and approved by Britax. For maximum safety only use accessories designed for this stroller.
- The maximum weight of the child using this product is not to exceed 17kg.
- Do not place more than 4kg in the basket, or 1kg in the canopy pocket (if supplied).

IMPORTANT

- The upright positions are not suitable for use with children less than six months old. The lowest recline position should be used to transport babies, the backrest can be adjusted to a more upright position as the child grows older and is able to support its head without assistance.

SAFETY WARNING

The sun is very strong. DO NOT LEAVE YOUR CHILD EXPOSED TO THE SUN. The canopy or hood on this product will not give your child total protection from the harmful rays of the sun.

01. TO OPEN THE STROLLER

- A Hold the stroller by the handles and release the storage latch.



- B Hold the handles and allow the front legs to drop towards the floor. Do not try to open the stroller by forcing the handles apart.



11. TO FOLD THE STROLLER

- A Close the canopy and place the backrest in the fully upright position. Apply the brakes and lock the swivel wheels.
- B Lift lower hinge at the bottom rear of the stroller using your foot.

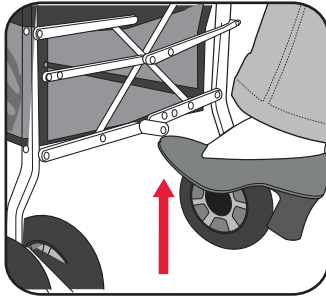

- C Then depress and release the secondary lock with your foot and push handles forward until the frame is fully folded.

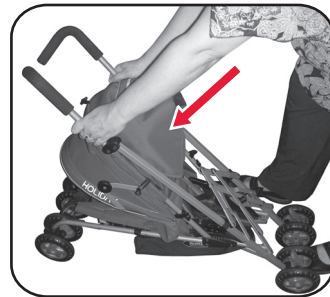
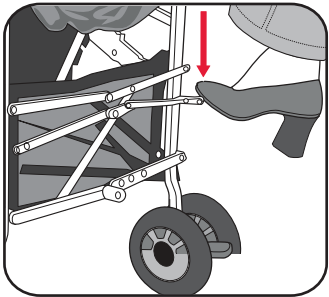

- D Apply the storage latch every time you fold the stroller

01. TO OPEN THE STROLLER

- C Push down on the lower locking bar until the frame is fully opened and locked.

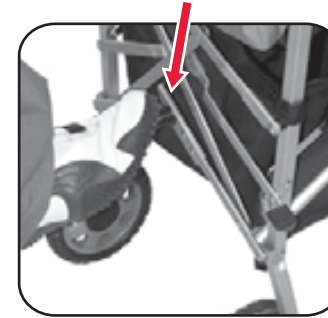

Note: Check that both the upper hinge and lower locking bar are fully engaged.

02. TO ASSEMBLE THE FRONT SWIVEL WHEELS

- A Take each front swivel wheel assembly and press it onto each of the front legs. Check that each wheel is fully engaged and secured by pulling against it.



03. TO USE THE SWIVEL WHEELS

A Lift the locking clip up to lock the swivel wheels.

Note: The swivel wheels should only be locked when the wheels are in the trailing position (wheels under frame). The wheels will automatically move into the trailing position when you move the stroller forward by approximately one metre. Always lock the swivel wheels when using the stroller on rough surfaces as this will minimise wheel wobble.

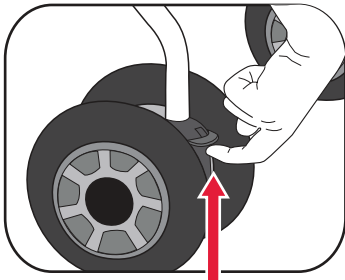

B Push the locking clip down to allow the wheels to swivel.

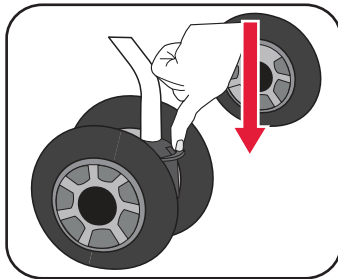

10. USING THE STROLLER

With your hand through the wrist tether strap loop, push the stroller holding both handles.

The stroller can be steered in the desired direction - allowing the front wheels to swivel will make this easier.

The front wheels may wobble or oscillate when walking fast. Locking the front swivel wheels will stop this.

The stroller can be taken up kerbs by either pressing down on the handles and raising the front wheels or turning the stroller around and pulling the stroller up the kerb.

Caution is required when pushing the stroller on a steep slope as the stroller may become unstable. Always hold the handles firmly.

Whenever you stop, always apply the brakes before you leave the stroller.

08. TO SECURE YOUR CHILD IN THE HARNESS (Cont)

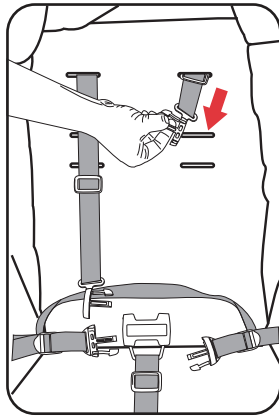

- H To reposition the harness, pull the shoulder harness buckle tongue through the desired slot.

09. TO USE THE TETHER STRAP

! WARNING: ALWAYS APPLY THE BRAKES WHEN THE STROLLER IS NOT MOVING. THE STROLLER MAY ROLL AWAY EVEN IF LEFT UNATTENDED FOR A FEW MOMENTS.

- A A wrist tether strap is provided near the handle grip. Slide your hand through the tether strap loop whenever you use the stroller. Only remove your hand from the tether strap loop when the brakes have been applied to the stroller wheels.



04. TO USE THE BRAKES

! WARNING: ALWAYS APPLY THE BRAKES WHEN THE STROLLER IS NOT MOVING. THE STROLLER MAY ROLL AWAY EVEN IF LEFT UNATTENDED FOR A FEW MOMENTS.

- A Push down on each brake lever to lock the brakes. Lift the brake lever up to release the brakes.



05. TO ADJUST THE LEG SUPPORT

- A Lower the leg support by pressing up the release latches located underneath on both sides of the leg support. Then push the leg support down. Raise the leg support by lifting it until the release latches lock into place.

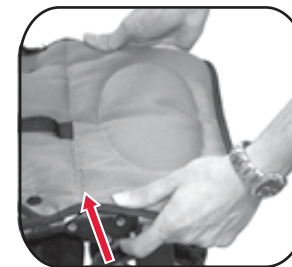

06. TO ADJUST THE BACKREST

! WARNING: ENSURE THAT YOUR CHILD'S LIMBS ARE IN THE CENTRE OF THE SEAT AND SUPPORT YOUR CHILD'S WEIGHT WHEN USING THE BACKREST.

- A Squeeze both the right hand and left hand latches fully and pull them back towards the rear of the stroller to the desired layback position. Lift the backrest to select a more upright seating position



07. TO ATTACH AND USE THE CANOPY

- A Attach the canopy clips to each side of the stroller frame by pushing the clips until they snap into place.



08. TO SECURE YOUR CHILD IN THE HARNESS (Cont)

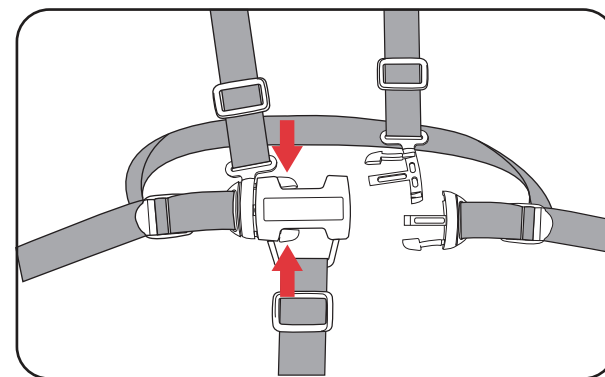

- F To release the buckle. Squeeze the top and buckle tongues together with enough pressure so the buckle tongues can release from the buckle housing.

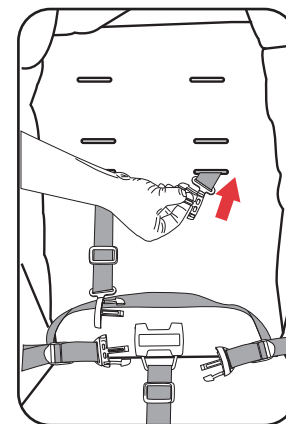

* Depending on the model

- G The stroller seat has *2 or 3 sets of harness slots at different heights to accommodate the child. To change the shoulder harness height, push the shoulder harness tongue out of the current harness slot and through the back of the seat.

08. TO SECURE YOUR CHILD IN THE HARNESS (Cont)

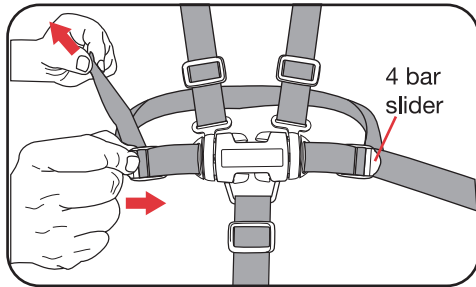

- D Tighten or loosen the waist straps, hold and lift the 4 bar slider and then pull the harness strap, to adjust to the desired fit. The waist strap needs to fit firmly around the child.

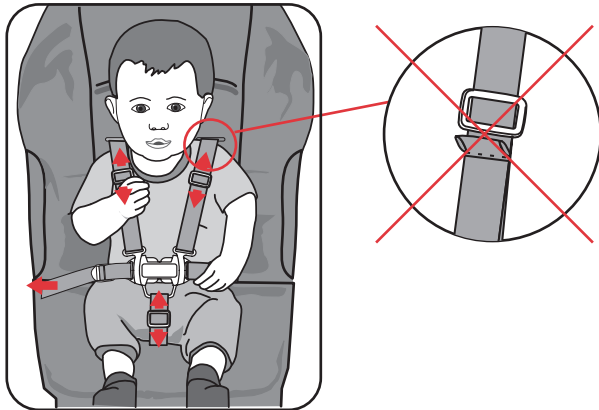

- E Tighten or loosen the shoulder straps, slide the 3 bar slider up or down to adjust to the desired fit. Always adjust the harness strap when changing the seating position of the child.

CAUTION: DO NOT SLIDE 3 BAR SLIDER OVER THE SEWN TAB ON SHOULDER HARNESS.

07. TO ATTACH AND USE THE CANOPY (Cont)

- B Thread elastic straps on both sides of canopy through the button hole in side panel and attach to the guide on canopy hinge.

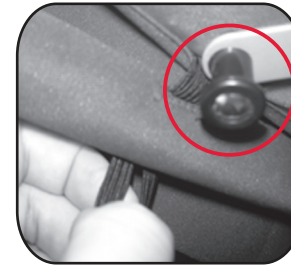

- C Open the canopy by pulling the front of the canopy forward and push the canopy hinges down on each side to lock into place.



- D To open the canopy window pull the flap away from the canopy. Roll the canopy window flap up and secure with the elastic loop and toggle.



WARNING: USE THE HARNESS AT ALL TIMES.

When not in use disconnect shoulder straps from the waist strap and buckle to prevent strangulation.

A five point harness is provided to restrain your child. Buckle tongues separate for added safety. To reconnect buckle tongues and to secure the child in the harness please follow the steps below carefully.

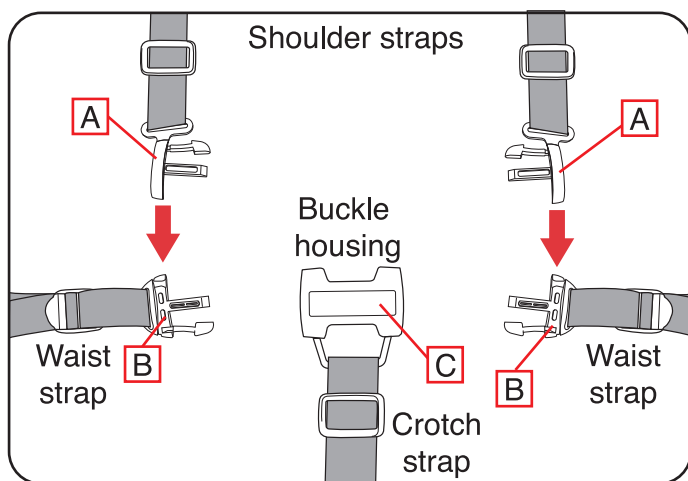

- A Position the shoulder strap tongue (A) on the top of the waist buckle tongue (B) on both sides.

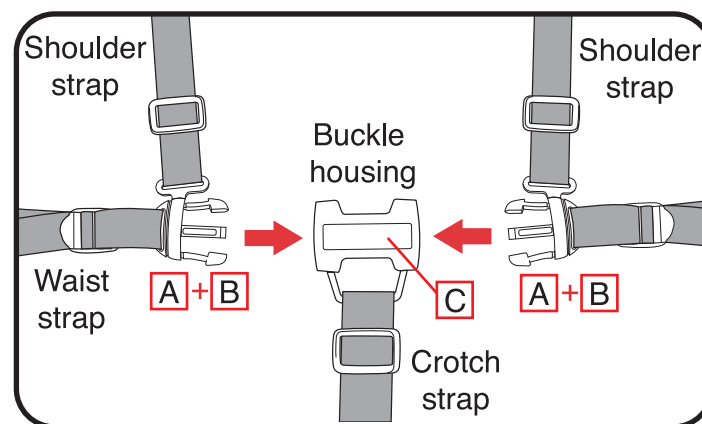

- B Push both buckle tongues (A+B) into the buckle housing (C) until the buckle tongues lock into position.

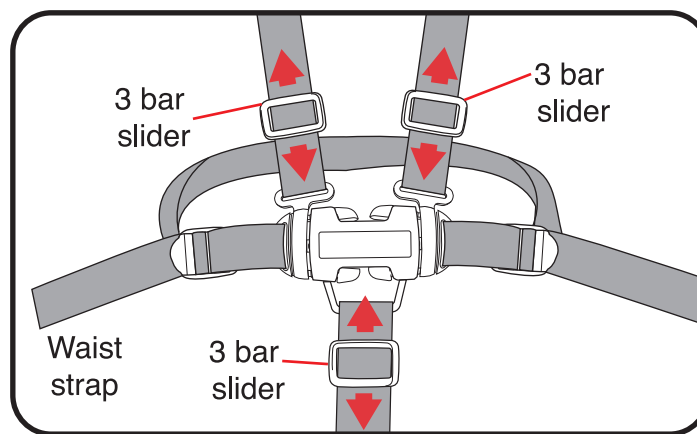

- C Tighten or loosen shoulder and crotch straps by sliding up and down the 3 bar sliders.